

# MAPPYSILENT

## Description

**MAPPYSILENT** is an acoustic insulation material consisting of an elastomeric high density barrier (EPDM), with the addition of minerals fillers that give it a high weight, specifically designed as a non-toxic alternative to lead plate. **MAPPYSILENT** does not contain bitumen and lead and it is also available in an adhesive version with hot-melt glue, to support the installer in the laying phase.

## Applications

**MAPPYSILENT** is ideal in all cases where a sound impedance material between adjacent rooms is required; it can be easily coupled to sheets for drywall (plasterboard, wood, magnesium) to increase the acoustic performance and be used on either walls or ceilings. Since it is made of elastic material it can be used in an adhesive version as damping and vibration for use on metal sheets.

## Laying

To reduce installation time, we recommend the use of the adhesive version as it is sufficient to remove the silicone film and attach the material to the surface; alternatively we recommend the use of our special **MAPPYCOL S45** glue (page 96). For application to concrete and masonry we advise the use of polypropylene rawlplugs.

**MAPPYSILENT** can easily be cut or shaped using a cutter.



## Renovations

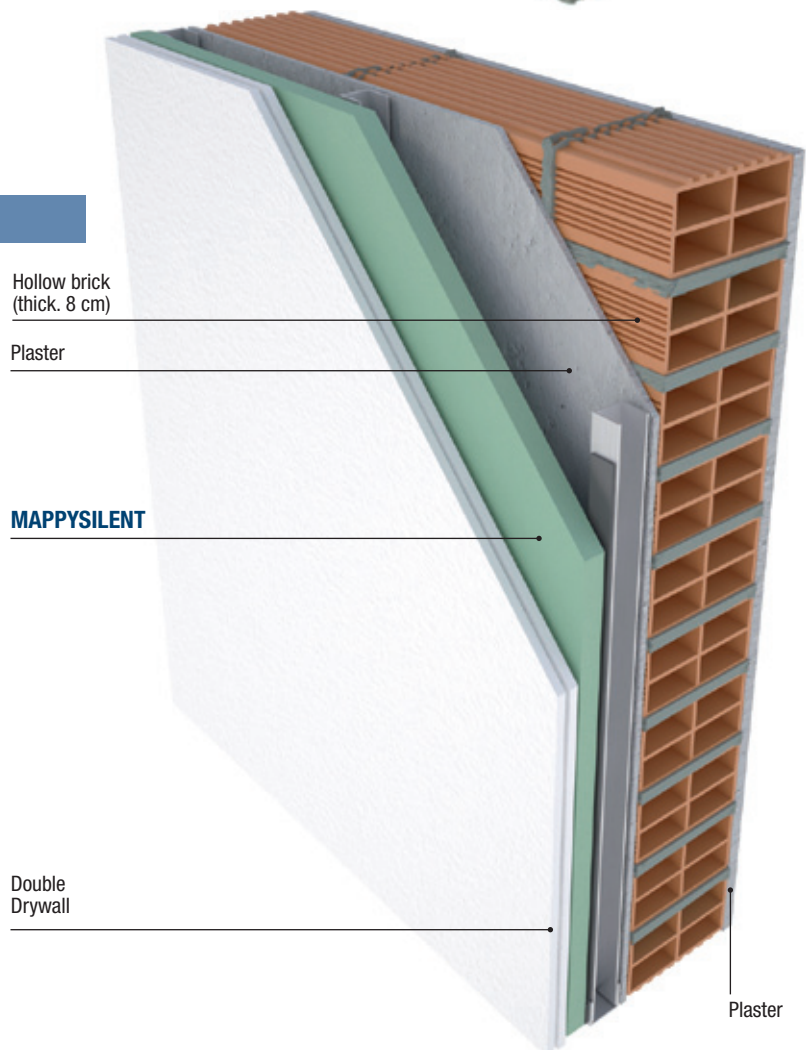

**ELASTOMERIC MASS****Colour****Weight**~ 4 kg/m<sup>2</sup>**Reaction to fire**It does not spread fire (ISO 3795)  
EUROCLASS E (EN 13501)**Acoustic insulation**R<sub>w</sub> = 52 db \*  
(UNI EN ISO 140-3:2006)  
R<sub>w</sub> = 56 db \*\***Certifications**

CE Marking

\* Plaster (thick 1,5 cm) + hollow bricks (thick 8 cm) + plaster (thick 1,5 cm) + cavity wall: drywall stud (thick 5 cm) + Mappysilent (thick 2 mm) + drywall (thick 1,25 cm, weight 11kg/m<sup>2</sup>)

\*\*\* Plaster (thick 1,5 cm) + hollow bricks (thick 8 cm) + plaster (thick 1,5 cm) + cavity wall: drywall stud (thick 5 cm) + Mappysilent (thick 2 mm) + double drywall (thick 1,25 cm, weight 11kg/m<sup>2</sup> each)

**Items**

	Code	W. (mm)	Thick. (mm)	Lg. (mt)	Colour Dis.	U.M.	No./ Pack.	Pack.	Dim.Pack. (cm)	Qty./ Pallet	RTS	Minimum
	G0200041000G010	1000	2	10	G	mq	150 mq	BA	120x80x90	150 mq	x	10 mq
	G0200041000G010	rolls diameter 18 cm										
	G02000412001000G	1200	2	1	G	mq	1 sheet	BA	120x120x45	125 sheets	x	1 sheet
Adhesive	G01H00412001000G	1200	2	1	G	mq	1 sheet	BA	120x120x45	125 sheets	x	1 sheet